

ITEM	QTY	DESCRIPTION
1	4	TOP CAP SCREWS
2	1	RING
3	1	E-CLIP
4	1	WASHER
5	1	O-RING
6	1	WASHER
7	1	SPRING
8	1	FUEL SCREW
9	1	FILTER
10	1	O-RING
11	1	NEEDLE VALVE ASSY
12	1	SCREW NEEDLE VALVE
13	1	GASKET BOWL
14	4	SCREW BOWL
15	1	SCREW DRAIN

MK-BST31-120
1996-2017 Suzuki DR200

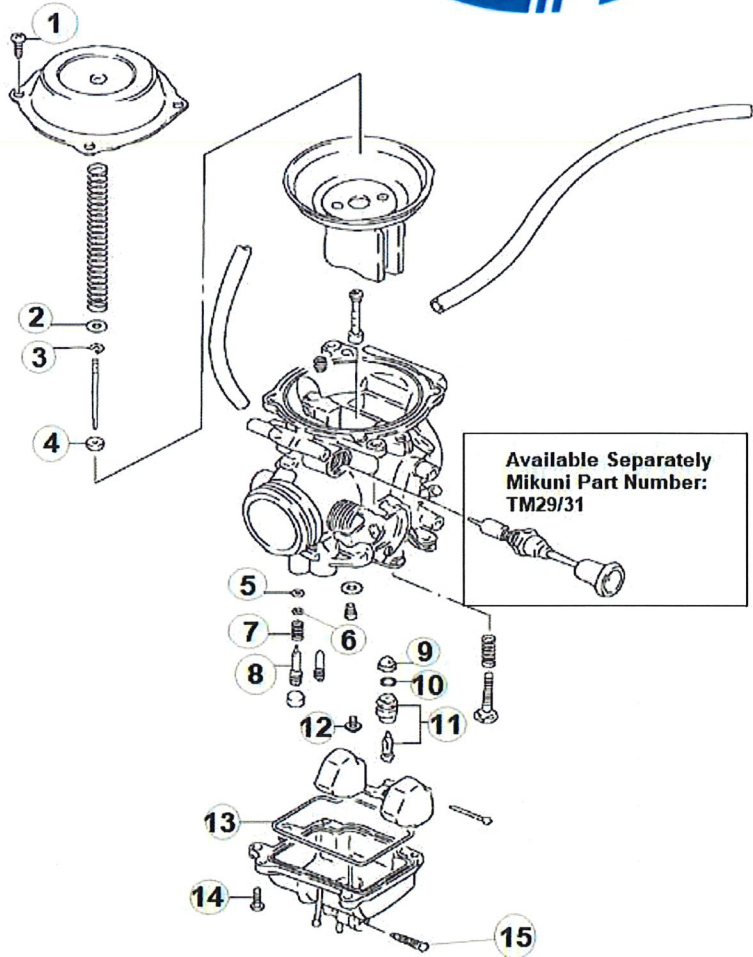

O-RING

WASHER

SPRING

FUEL SCREW

PLEASE NOTE THE CORRECT ASSEMBLY OF FUEL SCREW. THIS KIT CONTAINS 2 DIFFERENT FUEL SCREWS.

PLEASE USE CORRECT FUEL SCREW AS COMPARED TO THE ORIGINAL.

****REPLACEMENT JET NOTE**

Due to varying model requirements, this kit does not include main or pilot jets
If needed, refer to the following Mikuni Part numbers when acquiring these jets:
Main Jet: N100604-XXXX
Pilot Jet: N151067-XXXX

MIKUNI AMERICAN CORPORATION

www.mikunipower.com

HEAD OFFICE: 8910 MIKUNI AVENUE
NORTHRIDGE, CALIFORNIA 91324-3496
PHONES: (818) 885-1242
FAX: (818) 993-7387/8