

Item	Qty	Description
1	2	SCREW
2	1	DIAPHRAGM
3	1	RING
4	1	O-RING (JET NEEDLE)
5	1	SPRING (JET NEEDLE)
6	1	WASHER, <b>THICK</b> (JET NEEDLE)
7	1	E-RING (JET NEEDLE)
8	1	WASHER, <b>THIN</b> (JET NEEDLE)
9	1	O-RING (THROTTLE CABLE)
10	1	DIAPHRAGM
11	1	AIR CUT OFF SPRING
12	1	O-RING (NOZZLE)
13	1	PILOT SCREW SET
14	1	O-RING STARER CAP
15	1	NEEDLE VALVE SET
16	1	SCREW
17	1	SCREW
18	1	BOWL GASKET
19	3	SCREW (BOWL)
20	1	DRAIN PLUG
21	1	WASHER
22	1	SCREW

## MK-BSR33-66

### Yamaha Application:

2007-2009 Big Bear 250, 2005-2006 Bruin 250

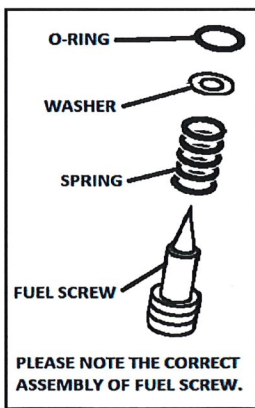
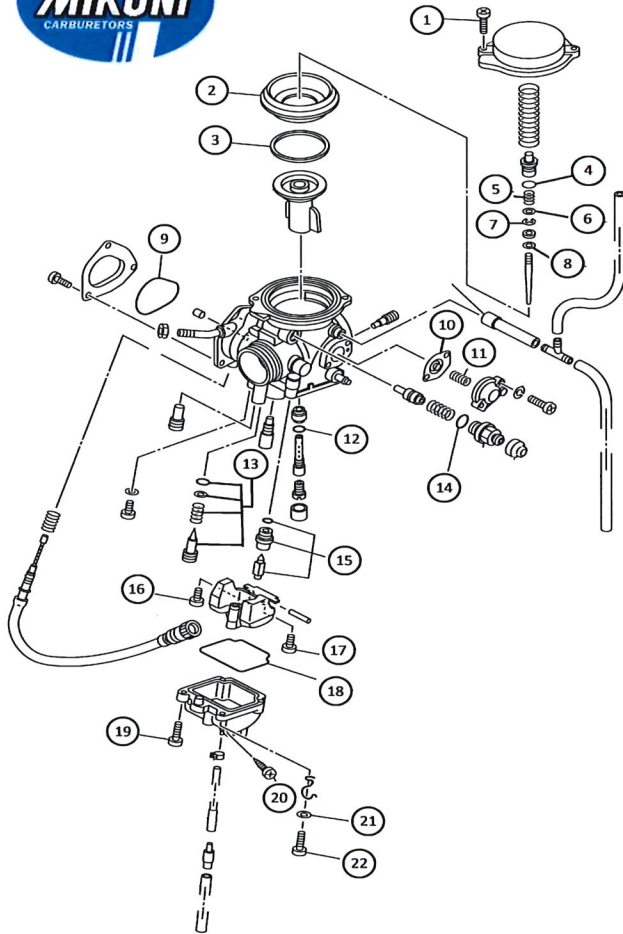

### \*\*REPLACEMENT JET NOTE

Due to varying model requirements, this kit does

not include main or pilot jets

If needed, refer to the following

Mikuni Part numbers when acquiring these jets:

Main Jet: N10221-XXXX

Pilot Jet: N224103-XXXX

**MIKUNI AMERICAN CORPORATION**

[www.mikunipower.com](http://www.mikunipower.com)

HEAD OFFICE: 8910 MIKUNI AVENUE  
NORTHRIDGE, CALIFORNIA 91324-3496  
PHONES: (818) 885-1242  
FAX: (818) 993-7387/8